

ISS	ECO	BY	CHK	DATE
A	—	—	—	—
B	65132	DWB	KRK	2017-07-06

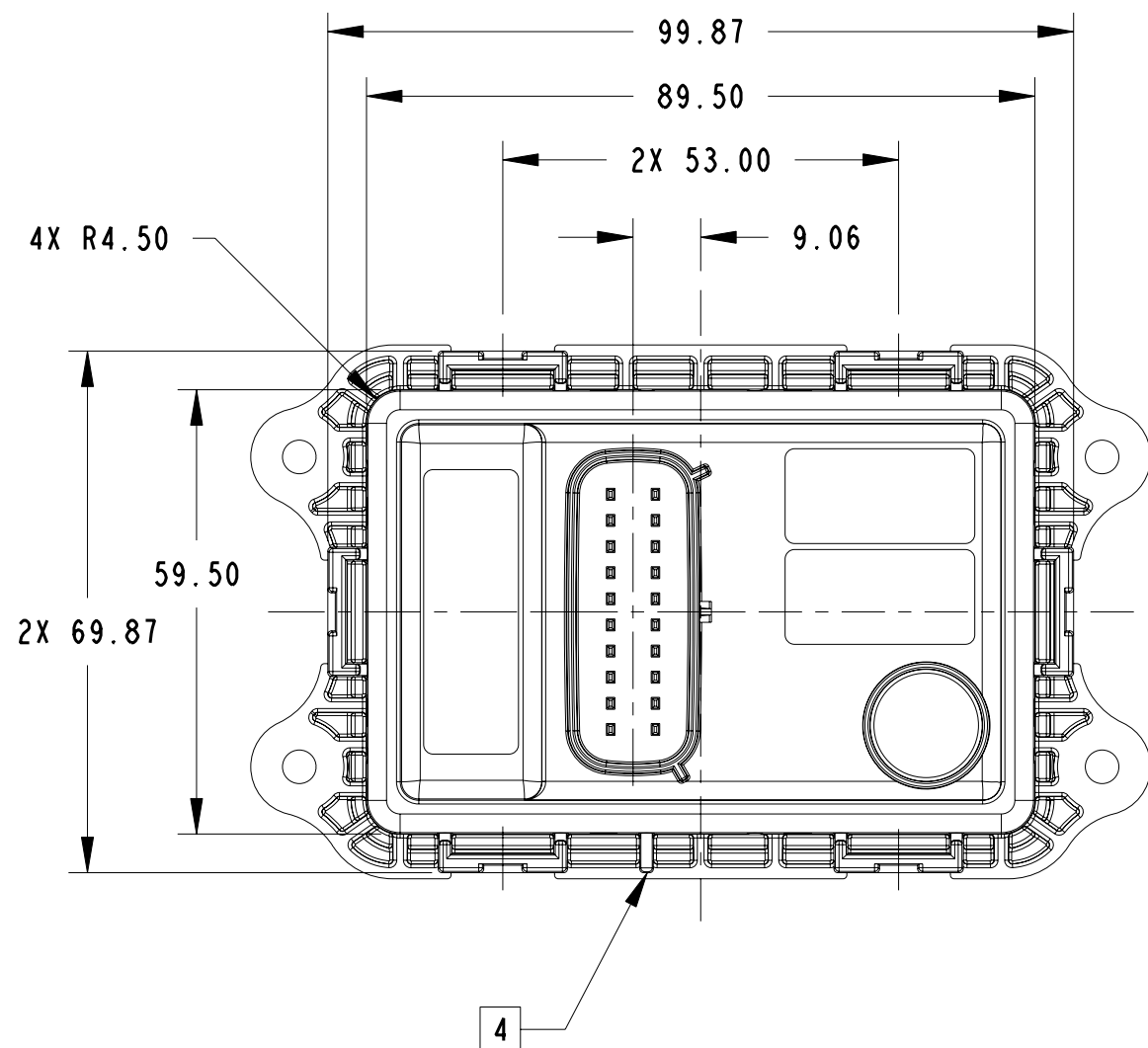
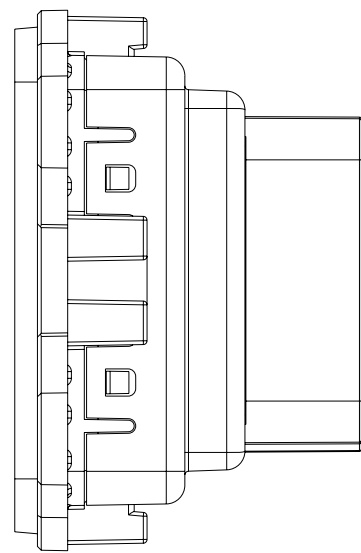
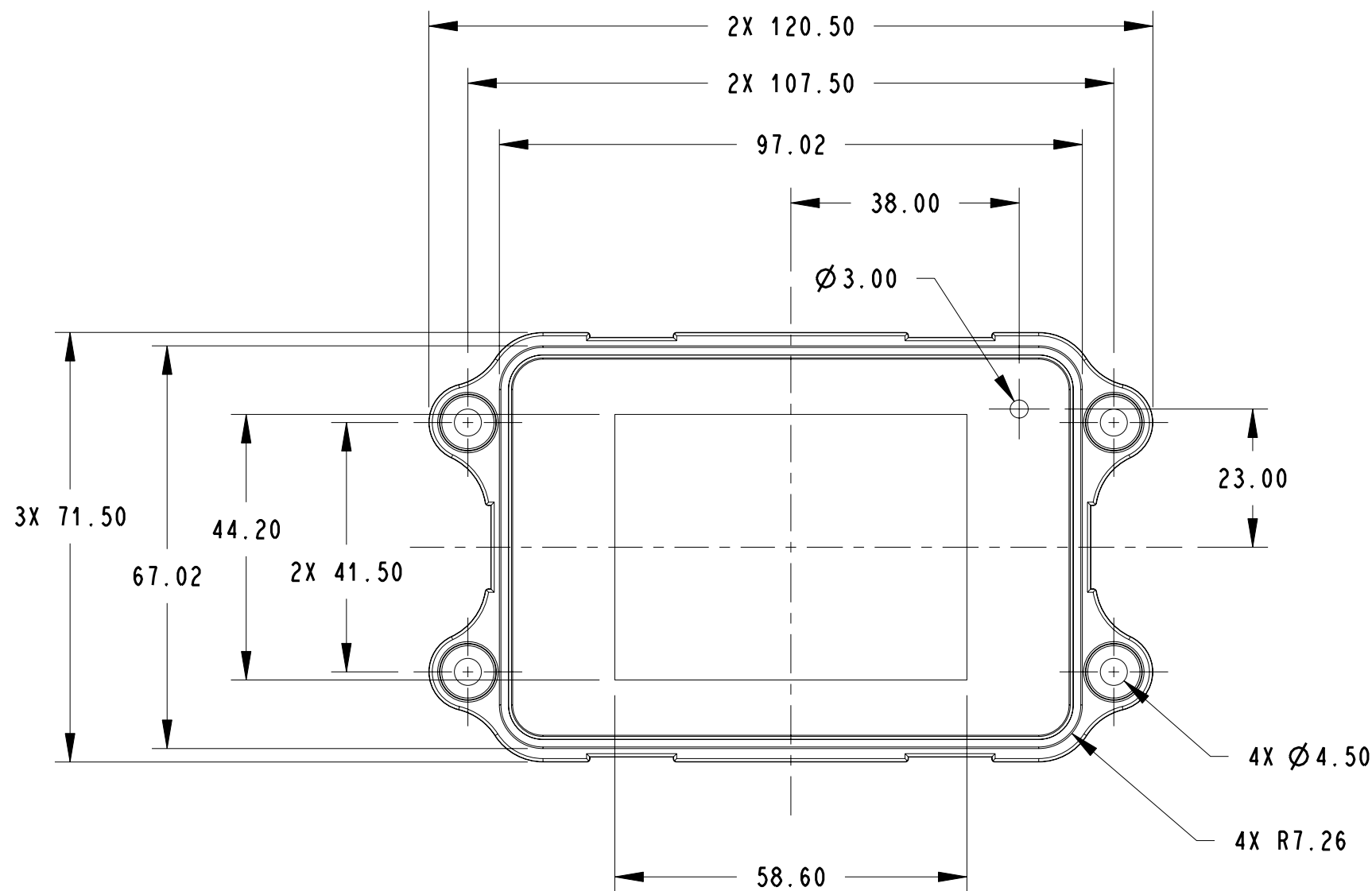
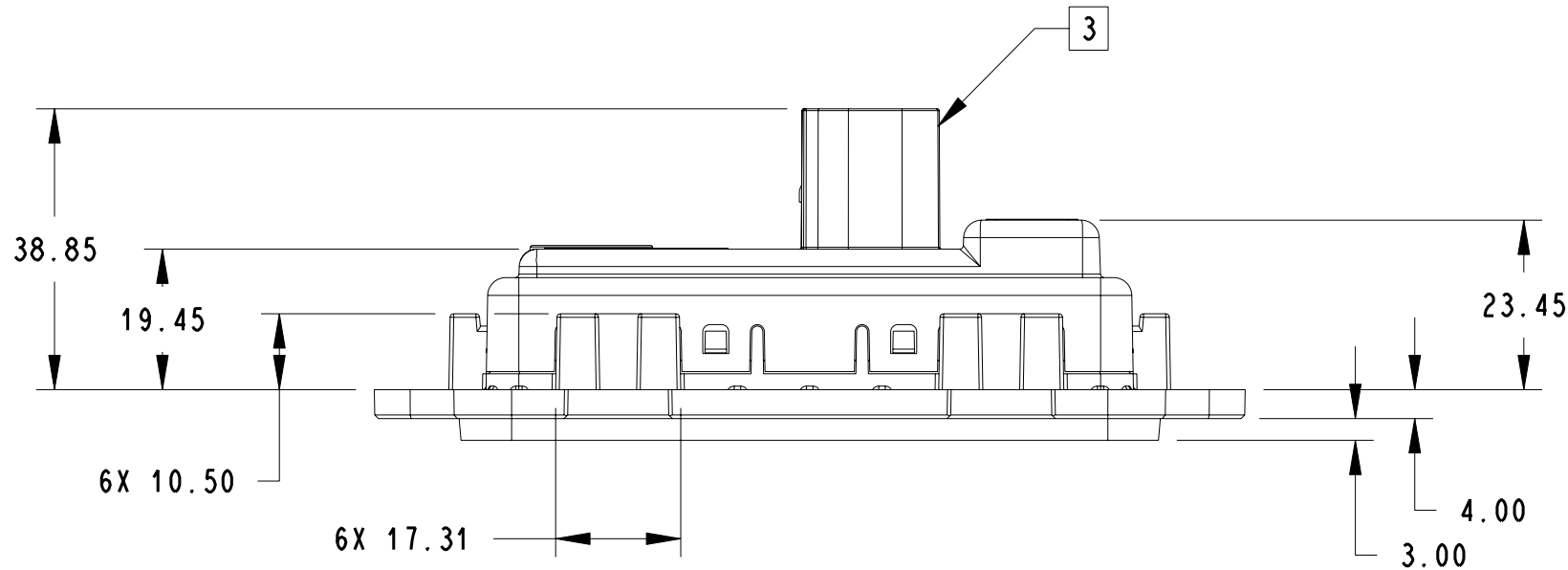

NOTES:

- PRODUCT MASS: APPROX. (130g)
- 3D CAD DATA FILE IS AVAILABLE FROM PARKER ENGINEERING UPON REQUEST.
- CONSIDERATION MUST BE MADE FOR CONNECTOR AND CABLE THAT WILL BE ATTACHED AND PROTRUDING FROM THE BACK OF THE UNIT.
- KEY FEATURE IN ENCLOSURE CAN BE USED TO PREVENT INSTALLING UNIT WITH INCORRECT ORIENTATION IN FRONT MOUNT APPLICATIONS. CONSIDERATION MUST BE MADE FOR THE KEY FEATURE IN PANEL CUTOUT DESIGN.
- THE MOUNTING DETAILS SHOWN IN THIS DRAWING ARE SUGGESTIONS ONLY. THE CUSTOMER IS RESPONSIBLE FOR DETERMINING SUITABLE MOUNTING PANEL GEOMETRY, MOUNTING PANEL MATERIALS, FASTENERS AND FASTENER TORQUE VALUES, AS REQUIRED FOR THEIR APPLICATION.
- THE PRODUCT DIMENSIONS SHOWN ARE NOMINAL AND ARE NOT TO BE USED FOR PART INSPECTION PURPOSES.

This document contains information that is confidential and proprietary to Parker Hannifin Corporation ("Parker"). It is not to be copied or disclosed to others or used for any purpose other than conducting business with Parker. The recipient of this document, through its own analysis and testing, is solely responsible for making the final selection of the applicable system and components and assuring that all performance, endurance, maintenance, safety and warning requirements of the application are met.

REV	ECO	BY	CHK	DATE

TOLERANCES
(UNLESS NOTED)

= ±
= ±
= ±

ANGLES = ±°

DSGN: N/A
DWN: D.BARTON
CHK: K.KORNIK
APVD: N/A

DATE: N/A
DATE: 2016-07-18
DATE: 2016-07-19
DATE: N/A



THIRD ANGLE PROJECTION



VANSCO

ELECTRONIC CONTROLS DIVISION
WINNIPEG, MB, CANADA

TITLE: PHD28 DISPLAY
MOUNTING INFORMATION

SAP: N/A
DWG NO: 1040B30
REV: 00
ISS: B

UNITS: mm
SCALE: 1.0
SHEET SIZE: C
SHEET 1 OF 4
Creo FILE: 1040B30.DRW Ver: 00.16 Rel: Released

SUGGESTED INSTALLATION
FRONT MOUNT USING METAL SPRING CLIPS
WITH OPTIONAL BEZEL

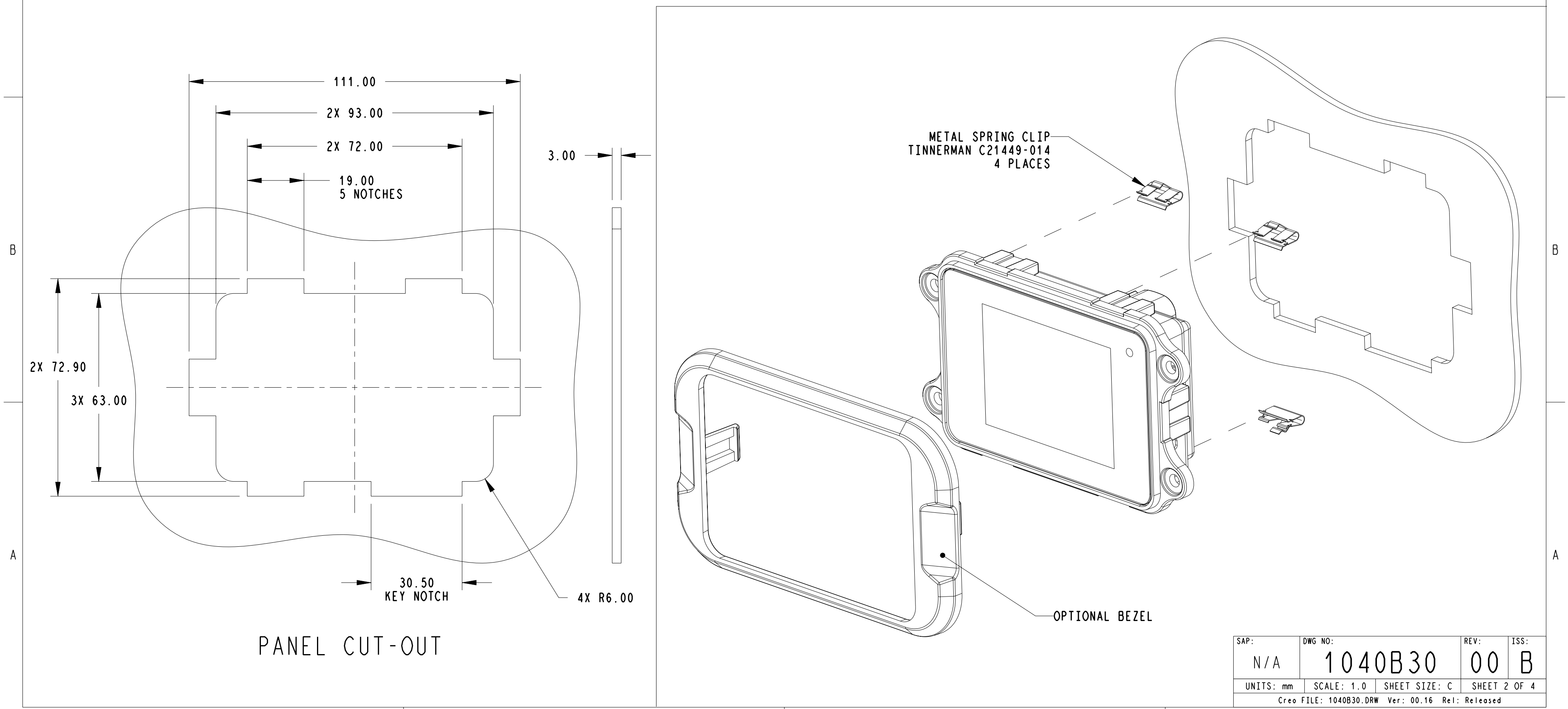
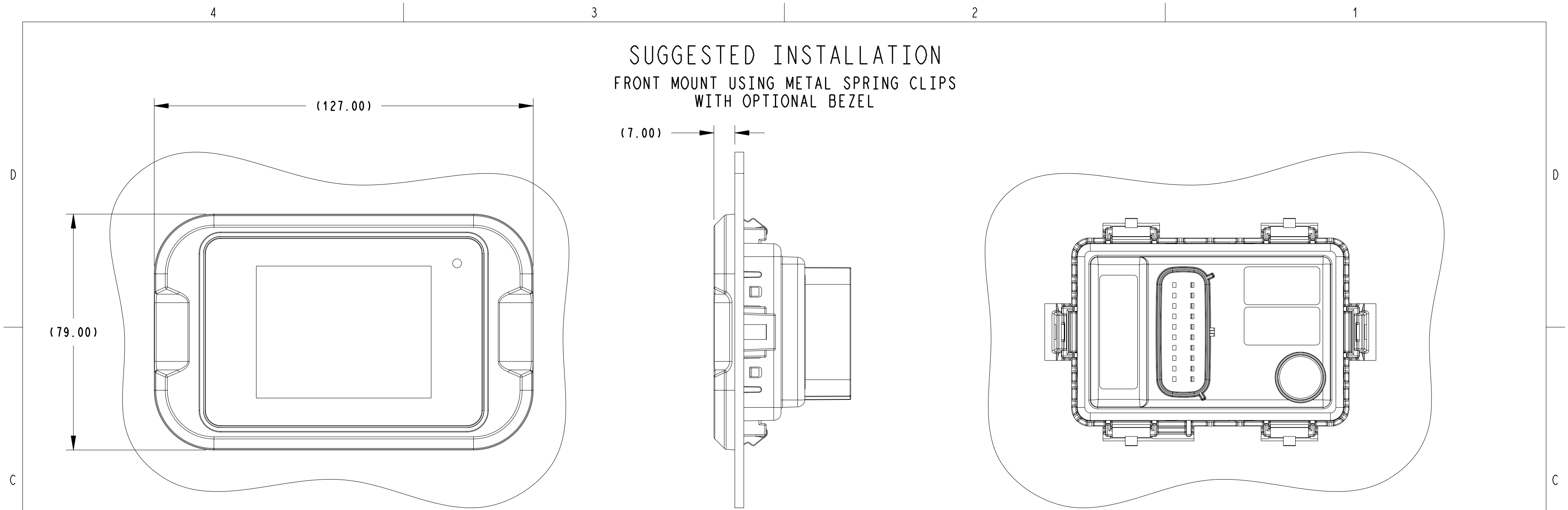

SAP:	DWG NO:	REV:	ISS:
N/A	1040B30	00	B
UNITS: mm	SCALE: 1.0	SHEET SIZE: C	SHEET 2 OF 4
Creo FILE: 1040B30.DRW Ver: 00.16 Rel: Released			

SUGGESTED INSTALLATION
FRONT MOUNT USING SCREWS AND PANEL INSERT NUTS
WITH OPTIONAL BEZEL

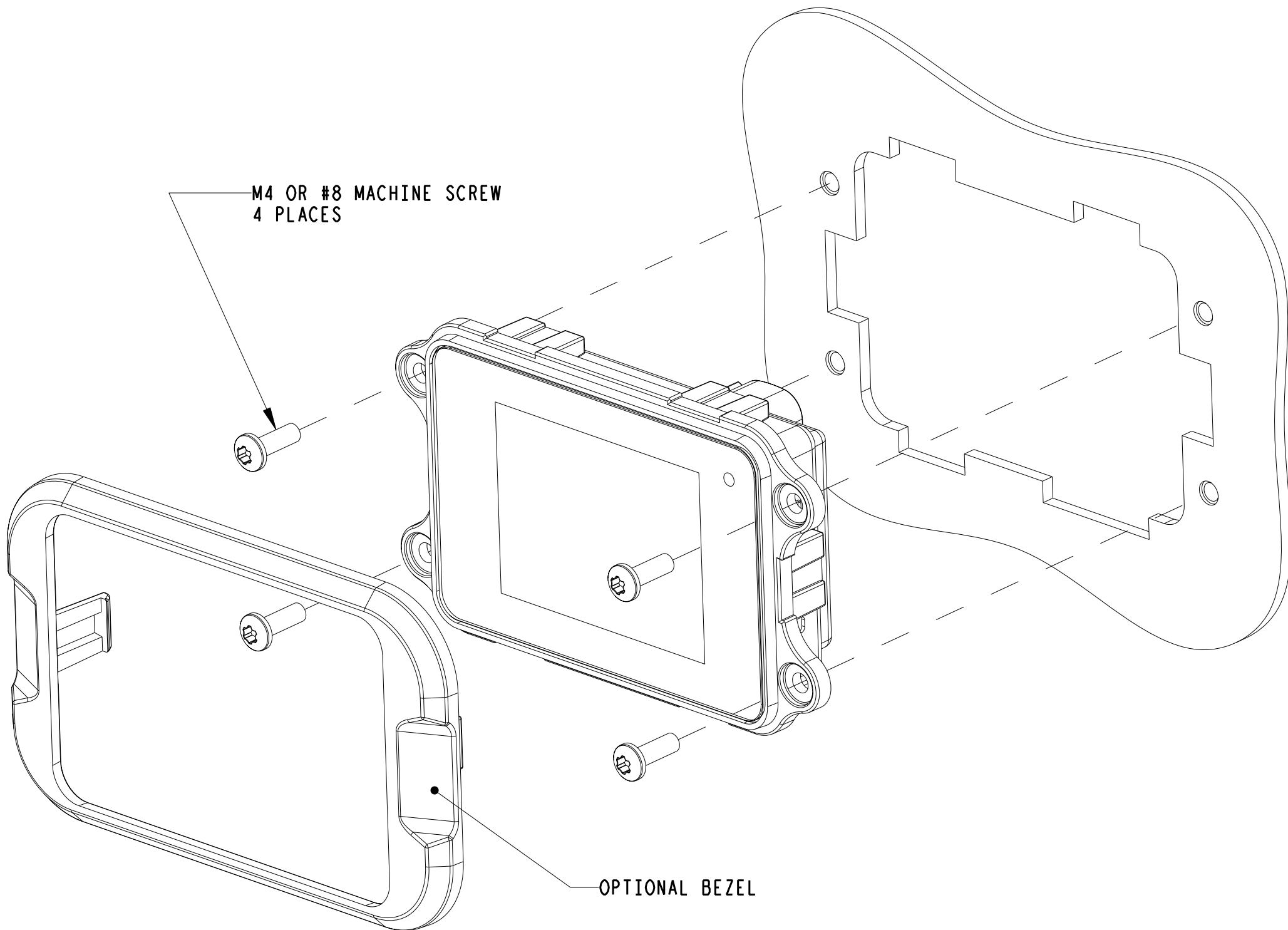
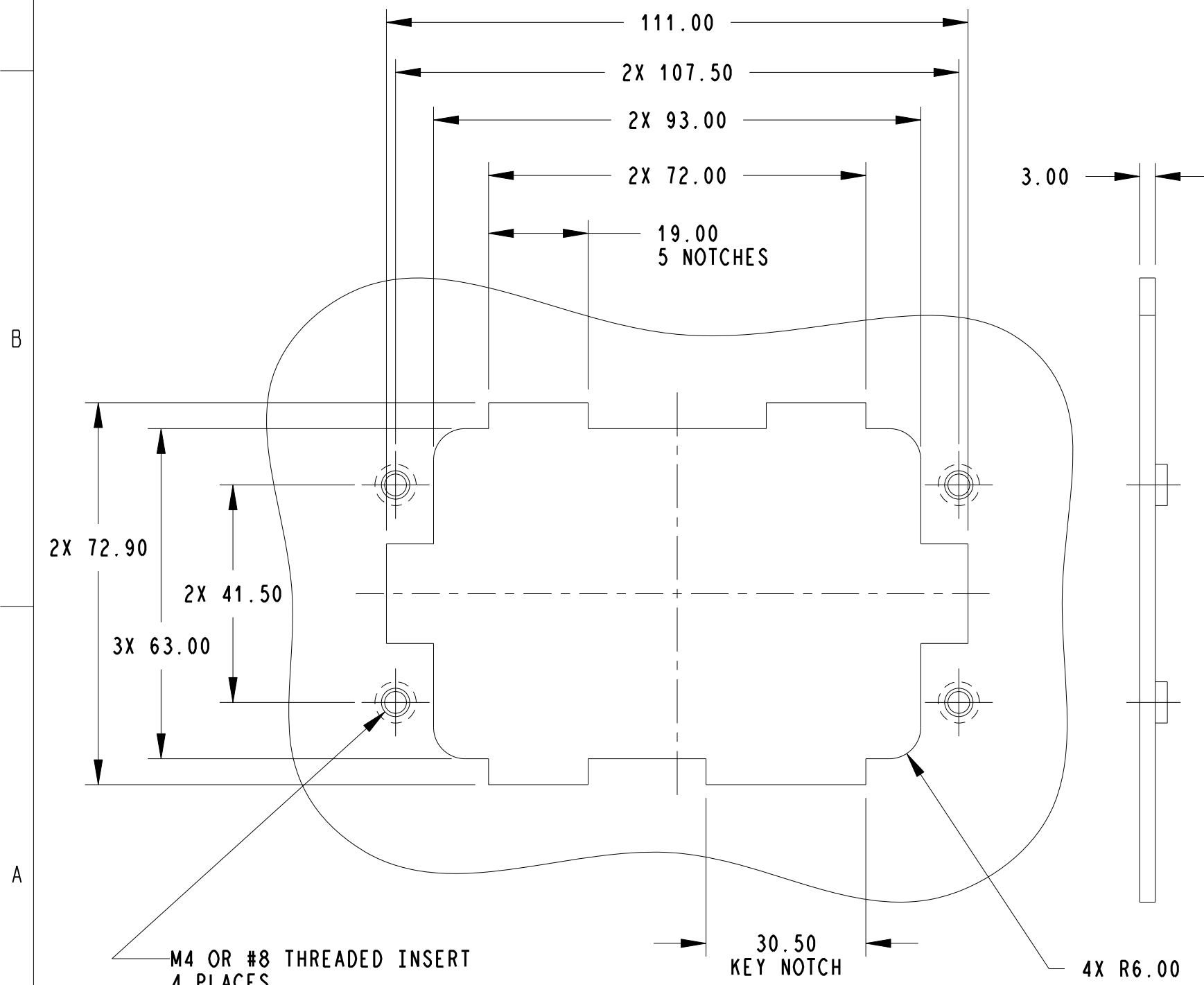
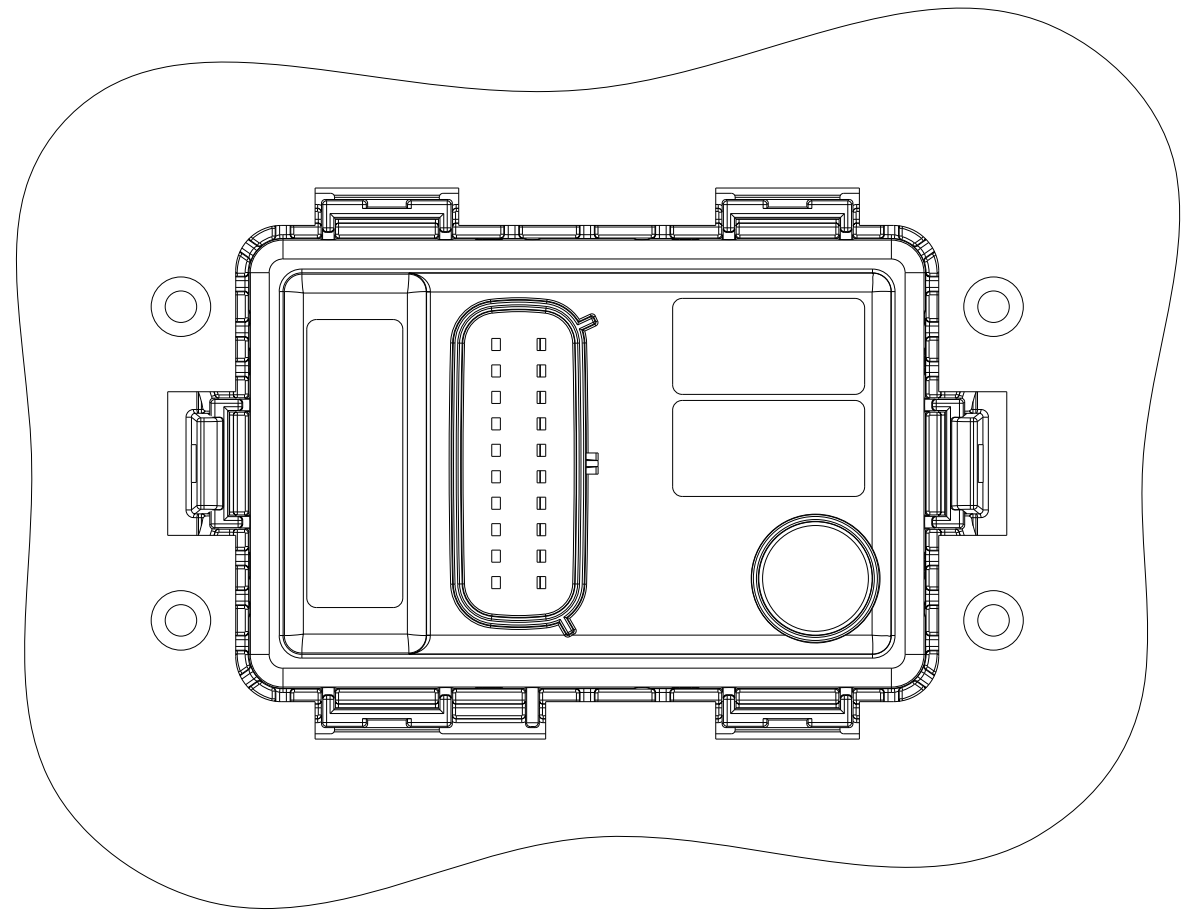
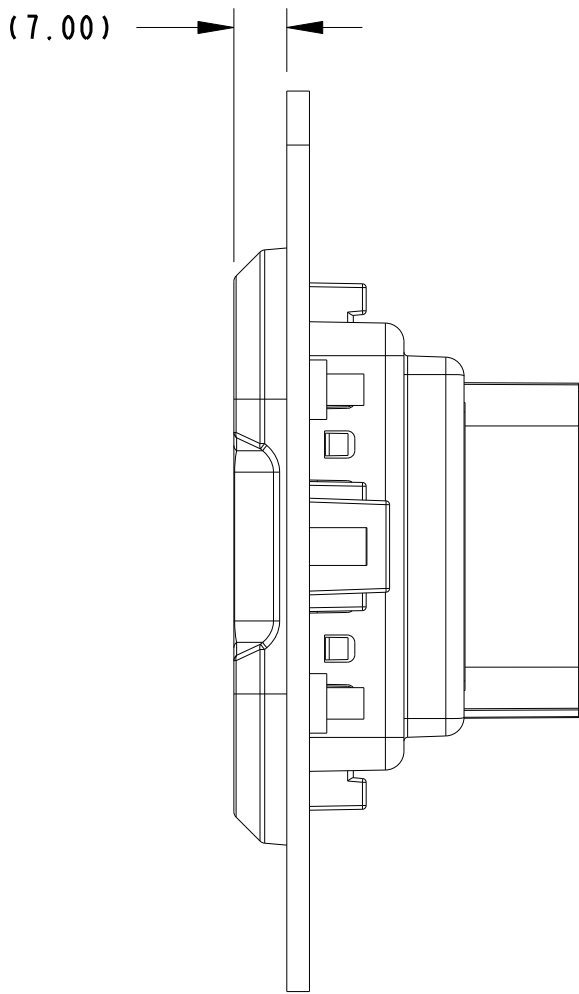
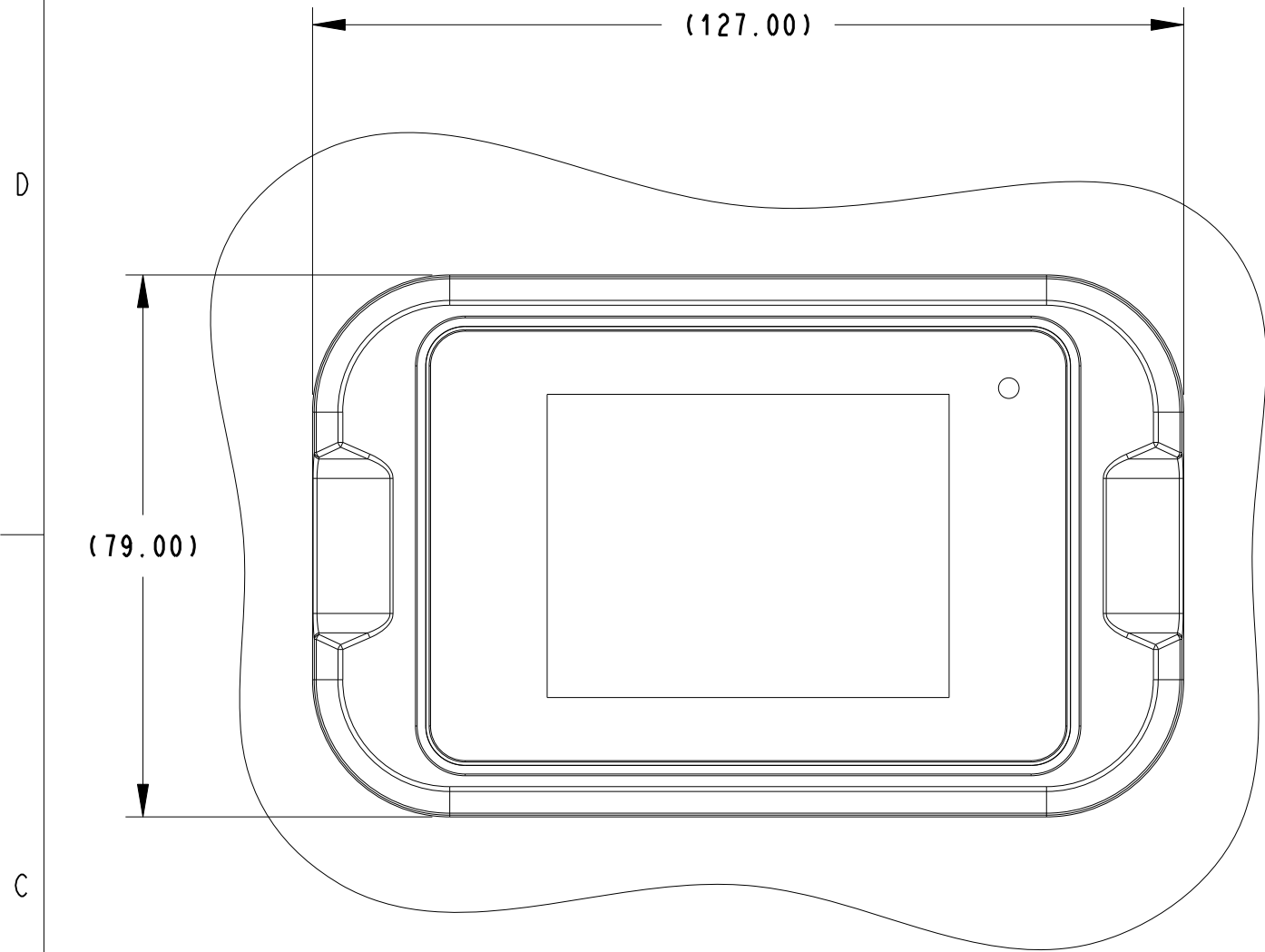

PANEL CUT-OUT

SAP:	DWG NO:	REV:	ISS:
N/A	1040B30	00	B
UNITS: mm	SCALE: 1.0	SHEET SIZE: C	SHEET 3 OF 4
Creo FILE: 1040B30.DRW Ver: 00.16 Rel: Released			

SUGGESTED INSTALLATION
REAR MOUNT USING PANEL INSERT STUDS AND NUTS

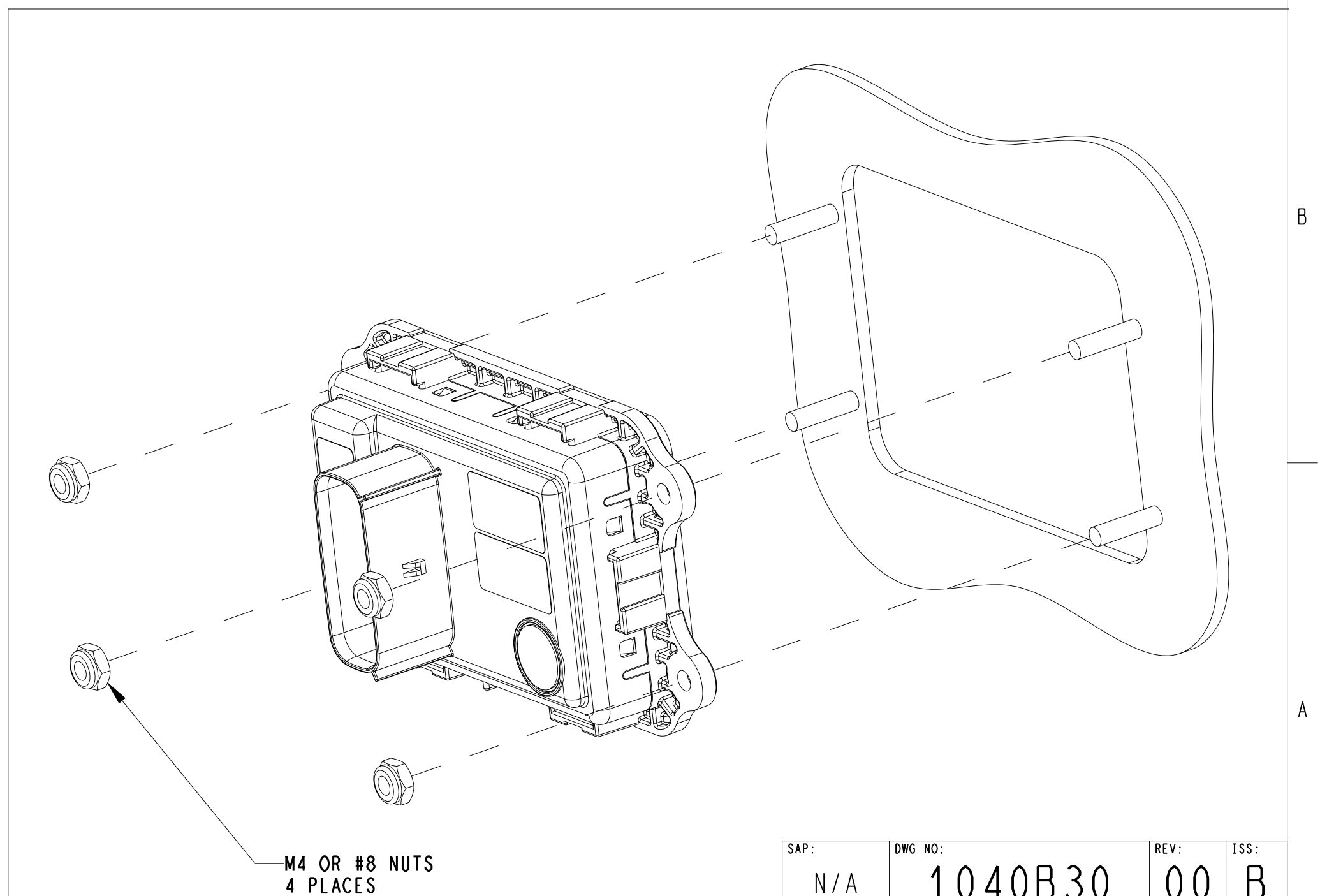
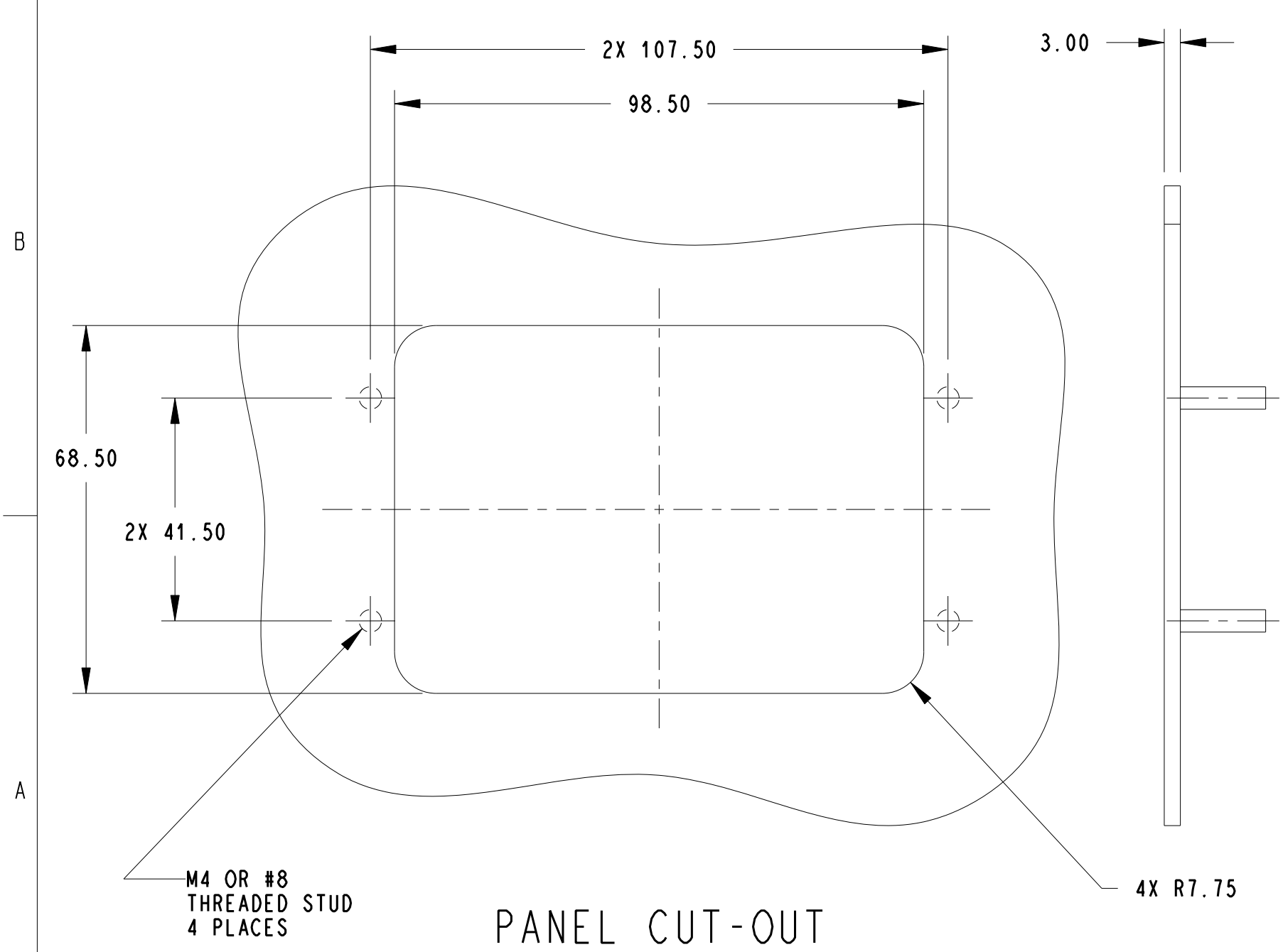
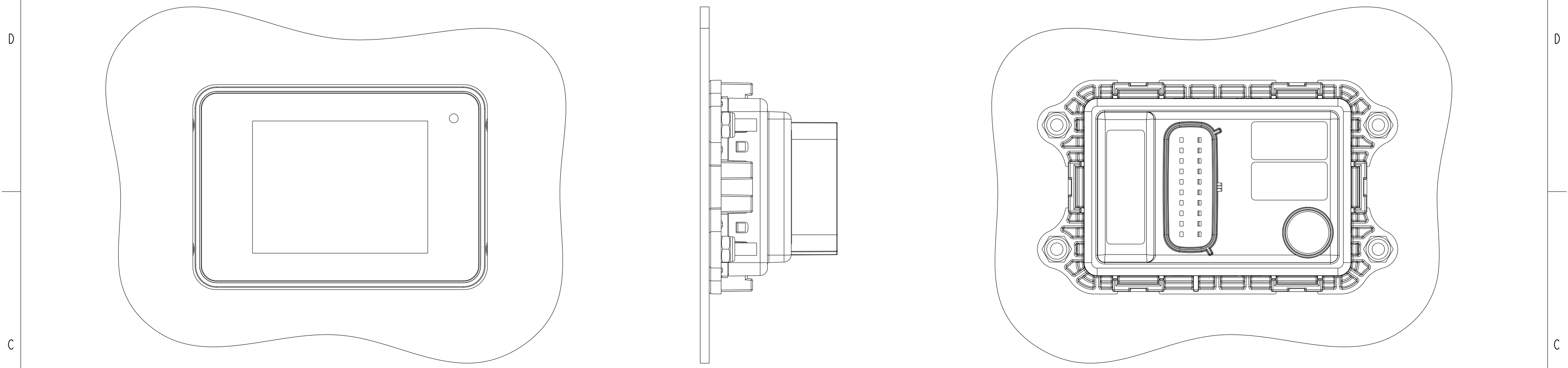

SAP:	DWG NO:	REV:	ISS:
N/A	1040B30	00	B
UNITS: mm	SCALE: 1.0	SHEET SIZE: C	SHEET 4 OF 4
Creo FILE: 1040B30.DRW Ver: 00.16 Rel: Released			